

## MR SDR 11

## FRIALEN Safety Fittings

Reducer, SDR 11

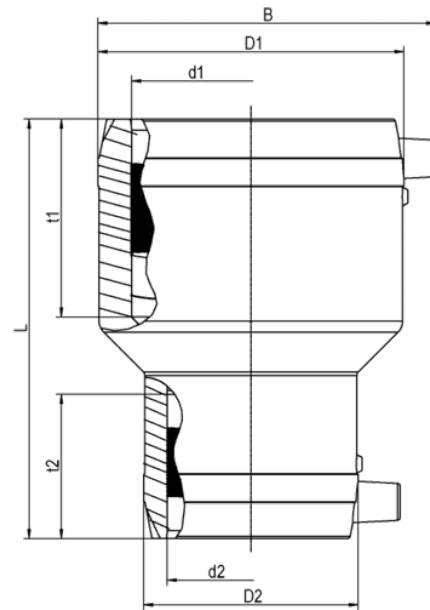

PE 100 SDR 11



Maximum working pressure 16 bar (water)/10 bar (gas)

	SKU	d <sub>1</sub>	d <sub>2</sub>	BX	PU	L	t <sub>1</sub>	t <sub>2</sub>	D <sub>1</sub> D <sub>2</sub>	B	Weight kg
1	616824	20	16	70	2240	75	36	36,00	32/28	44	0,035
	615386	32	20	80	2560	88	39	30,00	45/32	62	0,060
	615502	32	25	70	2240	88	39	33,00	45/38	62	0,070
	615387	40	20	60	1920	98	43	30,00	54/32	70	0,080
1	616751	40	25	120	1280	101	50	40,00	54/38	66	0,090
	615388	40	32	50	1600	98	43	39,00	54/45	70	0,090
	612069	50	20	32	1024	110	49	37,00	68/32	82	0,130
1	616752	50	25	130	960	107	52	39,00	66/38	77	0,120
	612070	50	32	32	1024	110	49	39,00	68/45	82	0,140
	612071	50	40	25	800	110	49	43,00	68/54	82	0,140
	615389	63	32	18	576	125	55	44,00	82/45	96	0,210
	615390	63	40	16	512	125	55	43,00	82/54	96	0,220
	612072	63	50	16	512	125	55	48,00	82/68	96	0,230
	616583	75	63	15	270	143	61	55,00	94/79	110	0,325
	615391	90	50	15	270	160	69	49,00	117/68	129	0,470
	615392	90	63	15	270	160	69	55,00	117/82	129	0,510
	616582	90	75	15	270	159	67	63,00	113/94	127	0,505
	615393	110	63	10	180	160	79	55,00	142/82	152	0,730
	615693	110	90	8	144	180	79	69,00	140/115	152	0,900
	615694	125	90	8	144	200	86	69,00	155/115	166	0,980
	616510	125	110	16	128	202	95	70,00	157/137	172	1,300
	615695	160	110	8	64	230	98	79,00	201/140	207	1,990
	616511	180	125	1	60	275	108	74,00	214/155	230	2,600

**MR SDR 11****FRIALEN Safety Fittings**

## Reducer, SDR 11

616356	225	160	1	36	270	110	98,00	282/203	283	4,860
--------	-----	-----	---	----	-----	-----	-------	---------	-----	-------

<sup>1</sup> Design deviates from product description

FRIALEN safety fittings can be fused to pipes SDR11 - SDR17.6 with exception of the dimensions d 125/110 and d 180/125. These dimensions can be fused to pipes SDR9 - SDR26. Minimum wall thickness  $s_{\min} \geq 3$  mm. Other SDR-stages on request. Please observe the marking directly at the product, which is mandatory. DVGW-Registration Nos. DV-8601AU2248 and DV-8606AU2249

**MR SDR 11****FRIALEN Safety Fittings**

Reducer, SDR 11

**Areas of Application**

The FRIALEN Electrofusion Reducer MR is applied for immediate pipe reduction within the pipe system.

**Assembly Instructions**

Fusing of pipe ends with the FRIALEN Electrofusion Reducers MR takes place by FRIALEN fusion – leakproof and longitudinally strong.

The pipe ends are prepared according to the general installation instructions (note "Assembly Instructions" for FRIALEN Safety Fittings for house connections and distribution pipes (remove oxide layer/clean).

**MR SDR 11****FRIALEN Safety Fittings**

Reducer, SDR 11

**Good reasons for using the FRIALEN Electrofusion Reducers MR:**

Large coupler depth for ease of pipe guiding (no holding clamps required)

Extra wide fusion zones

Maximum stability through great wall thickness

Cold zones at the front side and in the middle of the coupler

Exposed heating coil for direct heat transmission to the pipe

Small annular gap for build-up of optimum joining pressure in the fusion zone

Touch proof electric contacts

Fusion indicator for visual fusion control

Durable batch marking

Individually wrapped for dirt protection

Additional barcode for tracing back the underground fitting (Traceability-Coding)