

Order number: 06 405 06 99

SCHELL Straight screw connection with external thread

with compression screw connection

For copper pipe \varnothing 10

Details:

- Material: brass conform German drinking water regulation
- Surface: chrome
- Weight: 0.05 kg/pc.
- Packaging unit: 20
- Dimension: DN 15 G 1/2 ext. thread x DN 10 G 3/8 ext. thread

Versions:

Dimension: DN 10 G 3/8 ext. thread x DN 10 G 3/8 ext. thread Order No.: [06 400 06 99](#)
 For copper pipe \varnothing 8 mm, chrome, PU 20, W: 0.04 kg/pc.

Dimension: DN 10 G 3/8 ext. thread x DN 10 G 3/8 ext. thread Order No.: [06 401 06 99](#)
 For copper pipe \varnothing 10 mm, chrome, PU 20, W: 0.03 kg/pc.

Dimension: DN 15 G 1/2 ext. thread x DN 15 G 1/2 ext. thread Order No.: [06 402 06 99](#)
 For copper pipe \varnothing 12 mm, chrome, PU 20, W: 0.07 kg/pc.

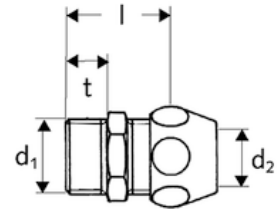

Order number: 06 412 06 99

SHELL Straight screw connection with internal thread

with compression screw connection

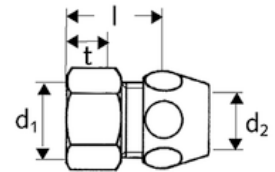
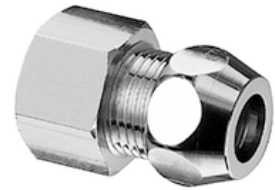
For copper pipe \varnothing 10 mm**Details:**

- Material: brass conform German drinking water regulation
- Surface: chrome
- Weight: 0.05 kg/pc.
- Packaging unit: 20
- Dimension: DN 15 G 1/2 int. thread x DN 10 G 3/8 ext. thread

Versions:Dimension: DN 10 G 3/8 int. thread x DN 10 G 3/8 ext. thread Order No.: [06 408 06 99](#)For copper pipe \varnothing 10 mm, chrome, PU 20, W: 0.05 kg/pc.Dimension: DN 15 G 1/2 int. thread x DN 15 G 1/2 ext. thread Order No.: [06 409 06 99](#)For copper pipe \varnothing 12 mm, chrome, PU 50, W: 0.08 kg/pc.

Order number: 06 437 06 99

SHELL Straight double screw connection

with two compression screw connections

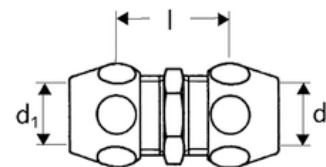
For copper pipe \varnothing 10 mm

Details:

- Material: brass conform German drinking water regulation
- Surface: chrome
- Weight: 0.05 kg/pc.
- Packaging unit: 20
- Dimension: DN 10 G 3/8 ext. thread x DN 10 G 3/8 ext. thread

Versions:

Dimension: DN 10 G 3/8 ext. thread x DN 10 G 3/8 ext. thread Order No.: [06 436 06 99](#)

For copper pipe \varnothing 8 mm, chrome, PU 20, W: 0.05 kg/pc.

Dimension: DN 15 G 1/2 ext. thread x DN 15 G 1/2 ext. thread Order No.: [06 438 06 99](#)

For copper pipe \varnothing 12 mm, chrome, PU 20, W: 0.11 kg/pc.

Dimension: DN 10 G 3/8 ext. thread x DN 10 G 3/8 ext. thread Order No.: [06 441 06 99](#)

For copper pipe \varnothing 10 mm x \varnothing 8 mm, chrome, PU 25, W: 0.05 kg/pc.

Dimension: DN 15 G 1/2 ext. thread x DN 10 G 3/8 ext. thread Order No.: [06 442 06 99](#)

For copper pipe \varnothing 12 x \varnothing 10, chrome, PU 25, W: 0.09 kg/pc.

Dimension: DN 10 G 3/8 ext. thread x DN 10 G 3/8 ext. thread Order No.: [06 529 06 99](#)

For copper pipe \varnothing 10 mm, chrome, PU 20, W: 0.06 kg/pc.